



Parent's Guide

Sleepy Owl Nightlight



VTech understands that a child's needs and abilities change as they grow and with that in mind we develop our toys to teach and entertain at just the right level...

vtech Baby

Toys that will stimulate their interest in different textures, sounds and colours

I am...

...responding to colours, sounds and textures

...understanding cause and effect

...learning to touch, reach, grasp, sit-up, crawl and toddle

Birth-36 months



Pre-School

Interactive toys to develop their imagination and encourage language development

I want...

...to get ready for school by starting to learn the alphabet and counting

...my learning to be as fun, easy and exciting as can be

...to show my creativity with drawing and music so my whole brain develops

3-6 years



Electronic Learning Computers

Cool, aspirational and inspiring computers for curriculum related learning

I need...

...challenging activities that can keep pace with my growing mind

...intelligent technology that adapts to my level of learning

...National Curriculum based content to support what I'm learning at school

4-10 years



To learn more about this and other VTech® products, visit www.vtech.co.uk

INTRODUCTION

Thank you for purchasing the **Sleepy Owl Nightlight** by **VTech®**! This adorable, sleepy-eyed owl projects a calming rotating image onto the ceiling to lull your little one to sleep. Choose between two sound modes to play sing-along songs, calming melodies or soothing noise. The delightful 3D nature scene inside the owl's tummy moves and is illuminated, bringing the scene to life.

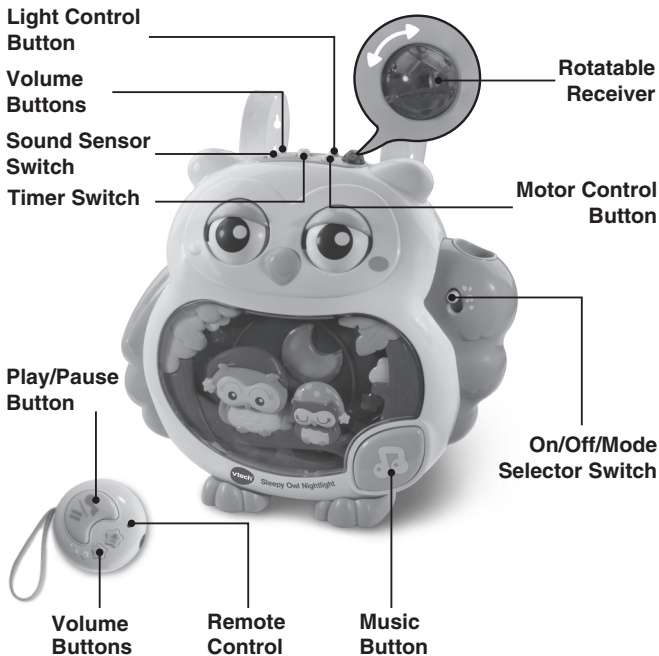

INCLUDED IN THIS PACKAGE

- One **Sleepy Owl Nightlight**
- One remote control
- Two adjustable cot straps
- One parent's guide

WARNING: All packing materials, such as tape, plastic sheets, packaging locks, removable tags, cable ties and packaging screws are not part of this toy, and should be discarded for your child's safety.

NOTE: Please keep this parent's guide as it contains important information.

Unlock the packaging locks:

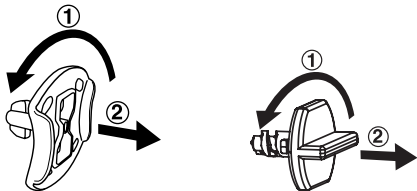

- ① Turn the packaging locks anticlockwise several times.
- ② Pull out and discard the packaging locks.

GETTING STARTED

BATTERY INSTALLATION

Sleepy Owl Nightlight

1. Make sure the unit is turned **OFF**.
2. Locate the battery cover on the back of the unit. Use a screwdriver to loosen the screw.
3. Install 4 new AA (LR6/AM-3) batteries following the diagram inside the battery box. (The use of new alkaline batteries is recommended for maximum performance).
4. Replace the battery cover and tighten the screw to secure.

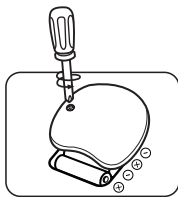

Remote Control

1. Locate the battery cover on the back of the **Remote Control**. Use a screwdriver to loosen the screw.
2. Install 2 new AAA (LR03/AM-4) batteries following the diagram inside the battery box.
3. Replace the battery cover and tighten the screw to secure.

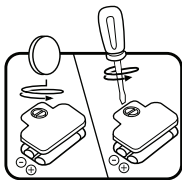

BATTERY NOTICE

- Use new alkaline batteries for maximum performance.
- Use only batteries of the same or equivalent type as recommended.
- Do not mix different types of batteries: alkaline, standard (carbon-zinc) or rechargeable, or new and used batteries.
- Do not use damaged batteries.
- Insert batteries with the correct polarity.
- Do not short-circuit the battery terminals.
- Remove exhausted batteries from the toy.
- Remove batteries during long periods of non-use.
- Do not dispose of batteries in fire.

- Do not charge non-rechargeable batteries.
- Remove rechargeable batteries from the toy before charging (if removable).
- Rechargeable batteries are only to be charged under adult supervision.

Disposal of batteries and product



The crossed-out wheellie bin symbols on products and batteries, or on their respective packaging, indicates they must not be disposed of in domestic waste as they contain substances that can be damaging to the environment and human health.



The chemical symbols Hg, Cd or Pb, where marked, indicate that the battery contains more than the specified value of mercury (Hg), cadmium (Cd) or lead (Pb) set out in Battery Directive (2006/66/EC).

The solid bar indicates that the product was placed on the market after 13th August, 2005.

Help protect the environment by disposing of your product or batteries responsibly.

For more information, please visit:

www.recycle-more.co.uk

www.recyclenow.com

ASSEMBLY INSTRUCTIONS

With the **VTech® Sleepy Owl Nightlight**, safety comes first.
To ensure your child's safety, adult assembly is required.

1. Slip one strap under a slot on the back of the unit. Then slip the other strap under the other slot.

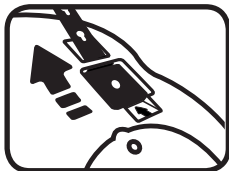
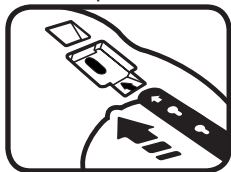

2. Place the unit against the bed rail bringing both straps over the top rail. Slip the top of the strap under the slot on the back of the unit and secure by choosing the appropriate hole. Repeat this procedure for the second strap.

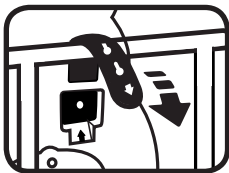

3. Fasten the cord on the back of the unit to the bed rail.

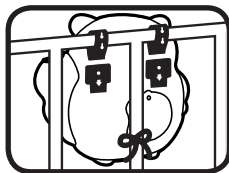

4. Pull slightly on the unit to make sure both straps have been securely fastened. The unit should be tight against the bed rail. Please check the unit frequently to ensure it is still secure.
5. The Sleepy Owl Nightlight can also be placed on a night stand, dresser or table.

NOTE:

Please check the unit frequently to ensure it is still secure. We recommend removing the **Sleepy Owl Nightlight** from the cot once your baby begins sitting or pushing up on all fours. At this time we suggest placing the **Sleepy Owl Nightlight** on a night stand, dresser or table.

When removing the **VTech® Sleepy Owl Nightlight** from the cot, please detach the cot attachment straps from the unit, and keep the straps out of your child's reach.

PRODUCT FEATURES

1. On/Off/Mode Selector Switch

To turn the unit **ON** slide the **On/Off/Mode Selector Switch** to select either **Lullaby Mode** or **Sound Mode**. You will hear sing-along songs and soothing melodies in **Lullaby Mode** and soothing sounds in **Sound Mode**. If a light mode is selected, the **Sleepy Owl Nightlight** will light up and the lights will twinkle to the music while the 3D image on the owl's tummy rotates.

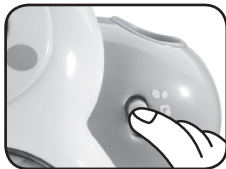

2. Timer Switch

Slide the **Timer Switch** to select the desired preset time. Once the timer has expired, the unit will enter sleep mode. Timer options include 10, 20 or 30 minutes.



3. Light Control Button

Press the **Light Control Button** to select one of four light modes.



4. Motor Control Button

Press the **Motor Control Button** to select one of three motor modes. Press to open or close the owl's eyes and to activate or deactivate the rotating background.



5. Music Button

In each mode, press the **Music Button** to play the next sound, melody or sing-along song depending on the selected mode.

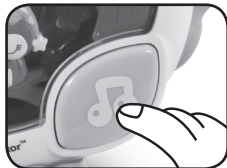

6. Sound Sensor Switch

Slide the **Sound Sensor Switch ON** or **OFF**. When the **Sound Sensor** is turned **ON**, it will activate the **Sleepy Owl Nightlight** to play soothing sounds or music when your baby cries. The sound sensor will only wake up the unit when the **Sound Sensor Switch** is **ON**. Once the selected time has expired, the unit will automatically power down.

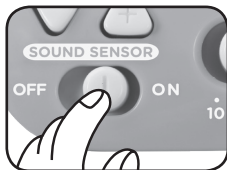

7. Volume Buttons

Press the **+ Button** to increase the volume or the **- Button** to decrease the volume.

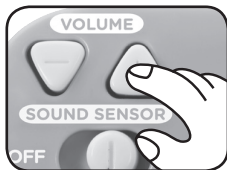

NOTE:

The unit's default volume level is level three when you first open the unit or when the batteries are changed. Once you have selected a volume level for your unit other than level one, the unit will remember that volume level each time you use the unit. If you have selected volume level one (silent mode) as your volume level, the unit will automatically default to volume level two once the unit has gone into sleep mode and is reactivated.

8. Remote Control

The **Remote Control** can start, pause and control the volume up to 30 feet away from the unit so not to disturb your baby. Be sure there are no obstructions directly between the **Remote Control** and the **Rotatable Receiver**. The **Remote Control** is disabled after 45 minutes without input.



NOTE:

Bright sunlight or artificial light may reduce the **Sleepy Owl Nightlight's** sensitivity to the **Remote Control**. To increase the reliability, reduce ambient light near the **Sleepy Owl Nightlight**.

9. Rotatable Receiver

The **Sleepy Owl Nightlight** features a **Rotatable Receiver** which can be rotated to receive an optimal signal from the **Remote Control**.

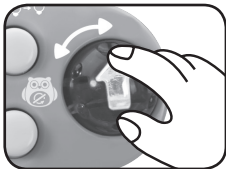

NOTE:

The **Rotatable Receiver** can be rotated 180 degrees clockwise and 90 degrees anticlockwise from original setting.

10. Reactivating the Unit

The unit can be reactivated by pressing any button on the unit (not including the **Sound Sensor Switch**), by using the **Remote Control** (if used within 45 minutes of going into sleep mode) or when the sound sensor is activated by your baby's cry.

NOTE:

This product is in try-me mode in the packaging. After opening the package, please remove the demo tag, then turn the unit off and on again to proceed with normal play. If the unit repeatedly powers down, we suggest changing the batteries.

ACTIVITIES

1. Lullaby Mode

Select **Lullaby Mode** to listen to the sing-along songs and soothing melodies.

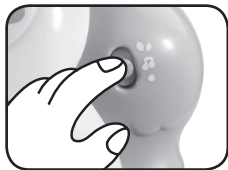

2. Sound Mode

Select **Sound Mode** to listen to a selection of soothing sounds.



3. Play/Pause Button on the Remote Control

Press the **Play/Pause Button** on the **Remote Control** to pause the sounds. Press it again to restart the sounds. If the unit is reactivated within 5 minutes the sing-along song, melody or soothing sounds will continue, but if the unit is paused for more than 5 minutes when reactivated, the next response will play.



4. Volume Buttons on the Remote Control

Press the **+ Button** to increase the volume or the **- Button** to decrease the volume.



NOTE:

Point the **Remote Control** directly at the front of the **Rotatable Receiver** and within 30 feet of the unit for an optimal signal.

MELODY LIST:

1. Au Clair de la Lune
2. Are you Sleeping?
3. Alouette
4. Adagio
5. All Through the Night
6. BINGO
7. Brahms' Lullaby
8. Blue Danube Waltz
9. Clementine
10. Concerto in C Major, 1st Movement
11. Canon in D
12. Cradle Song
13. Casse-Noisette Ouverture
14. Berceuse
15. Dance of the Sugar Plum Fairy
16. Did You Ever See a Lassie?
17. Clair de Lune
18. Greensleeves
19. Eine kleine Nachtmusik
20. Four Seasons - Spring, 1st movement
21. Four Seasons - Spring, 3rd movement
22. Four Seasons - Autumn, 1st movement
23. Four Seasons - Autumn, 3rd movement
24. Four Seasons - Winter, 2nd movement
25. Für Elise
26. Glow Worm
27. Hey Diddle Diddle
28. Roses are Red
29. Hush Little Baby
30. Happy Farmer
31. Little Robin Redbreast
32. Klipp-Klapp Galopp
33. Kinderscene Op.15
34. Listen to the Mockingbird

35. Little Bo Peep
36. Little Miss Muffet
37. Little Boy Blue
38. London Bridge
39. Piano Sonata in C, K. 545, 1st Movement
40. L'Empereur

SONG 1

(Tune of "Hush, Little Baby")

Hush little baby, it's time to dream.
In the morning the sun will beam.

SONG 2

(Tune of "Rock-a-Bye Baby")

Rock-a-bye baby, it's time to sleep.
Eyes shut tight 'til morning light.
Baby is sleepy, cosy and calm.
Now sleep tight little baby, I'll see you at dawn.

SONG 3

(Tune of "Lavender's Blue")

When nightfall comes dilly dilly,
I sing for you.
I'll sing so softly dilly dilly,
Rest your sweet head.

CARE & MAINTENANCE

1. Keep the unit clean by wiping it with a slightly damp cloth.
2. Keep the unit out of direct sunlight and away from any direct heat source.
3. Remove the batteries when the unit is not in use for an extended period of time.
4. Do not drop the unit on hard surfaces and do not expose the unit to moisture or water.

TROUBLESHOOTING

If for some reason the unit stops working or malfunctions, please follow these steps:

1. Please turn the unit **OFF**.
2. Interrupt the power supply by removing the batteries.
3. Let the unit stand for a few minutes, then replace the batteries.
4. Turn the unit **ON**. The unit should now be ready to play again.
5. If the product still does not work, install a new set of batteries.

If the problem persists, please call our Consumer Services Department on 01235 546810 (from UK) or +44 1235 546810 (outside UK) and a service representative will be happy to help you.

IMPORTANT NOTE:

Creating and developing **VTech®** products is accompanied by a responsibility that we at **VTech®** take very seriously. We make every effort to ensure the accuracy of the information, which forms the value of our products. However, errors sometimes can occur. It is important for you to know that we stand behind our products and encourage you to call our Consumer Services Department on 01235 546810 (from UK) or +44 1235 546 810 (outside UK), with any problems and/or suggestions that you might have. A service representative will be happy to help you.

CLASS 1
LED PRODUCT



PRODUCT REGISTRATION

Visit www.vtech.co.uk/clubvtech/login
to register your VTech product

By joining the VTech Club you can also enter competitions, find out about news and events, seek expert advice for parents and let your kids play fun learning games and activities.



PRODUCT WARRANTY

Thank you for choosing this quality product from VTech. We hope it will bring many hours of entertainment, imaginative play and learning.

1. The product detailed above is covered by a one year warranty from the date of purchase, against any defects in materials or workmanship.
2. The product may be returned to the place of purchase. Alternatively the product can be returned to VTech Electronics Europe plc (see address below), with proof of purchase, without proof of purchase no replacement will be provided.
3. VTech Electronics Europe plc will examine the product and if it is found to be defective due to faulty materials or workmanship, will replace the product at their discretion.
4. If the product covered by this warranty is damaged due to misuse, modification or unauthorised repair, or because of faulty batteries, battery discharge or incorrect electrical connections, then this warranty becomes void.
5. This warranty is personal to the original purchaser and is not transferable.
6. Breakages to the LCD screen are not covered by the warranty.
7. Returns to VTech Electronics Europe plc should include a cheque or postal order for £1.50 towards the cost of return postage and packaging.
8. Products returned to VTech Electronics Europe plc, should be addressed as follows and packed carefully to avoid damage in transit (Please do not include batteries or adaptor). Please include details of the fault together with your name and address.
9. To keep an online record of your warranty, please register your product online at www.vtech.co.uk/warranty

Vtech Electronics EU PLC, c/o XPO Logistics, Warehouse 350, Cat & Fiddle Lane, West Hallam, DE7 6HE

THIS WARRANTY IS OFFERED AS AN EXTRA BENEFIT AND DOES NOT AFFECT CONSUMERS' STATUTORY RIGHTS.

This warranty is valid for the UK and Eire only. For products purchased outside the UK and Eire, please contact your local distributor or place of purchase.



**Visit our website for more
information about our products,
downloads, resources and more.**

www.vtech.co.uk



TM & © 2017 VTech Holdings Limited.

All rights reserved.

Printed in China.

91-003346-001 